



# ZLJM-250D

Series contactors  
系列接触器

### 1 产品型号含义 Nomination(nomogram)

ZLJM - 250D / □ · S

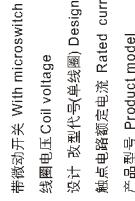

### 2 使用条件 Use conditions required

- 环境温度 Ambient temperature: -25~+40°C
- 相对湿度 Relative humidity: +20°C达98%(up to 98% at +20°C)
- 固定处的振动频率 Vibration freq. at the fixed position:  
3g, 1~50Hz 振幅 0.5mm  
3g, 1~50Hz ampli 0.5mm
- 安装方向 Mounting directions:  
触点向上及水平位置

The contactors can be mounted vertically or horizontally, if mounted vertically, the coil should be at the bottom

### 外形安装图 Configurational mounting diagram

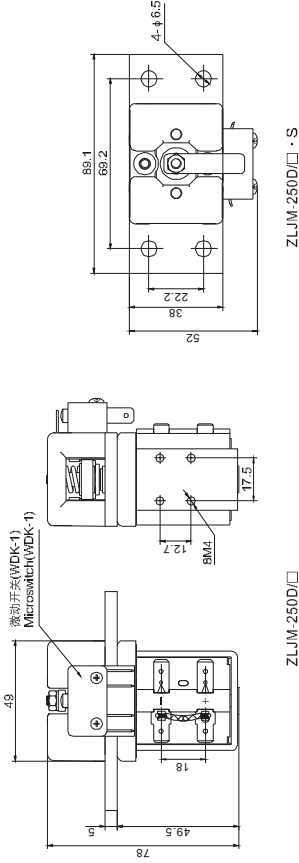

### 2 线路原理图 Circuit diagram

- 1-线圈单型(SPSTNO.)
- 3, 4-触点引出线(3, 4 contact terminal)
- 1, 2-线圈引出线(1, 2 coil terminal)
- L-线圈(Liswinding)

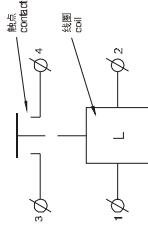

- 1-线圈单型(SPSTNO.)
- 带微动开关(With Microswitch)
- 3, 4-触点引出线(3, 4 contact terminal)
- 1, 2-线圈引出线(1, 2 coil terminal)
- L-线圈(Liswinding)
- A, B, C, D-微动开关接线端(A, B, C, D aux contact terminal)

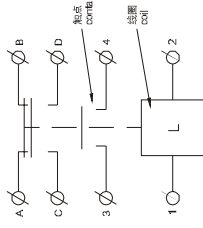

### 2 简要技术参数 Basic technical data

| 序号 NO. | 参数名称 Parameters   | 产品代号 Product code                                  |
|--------|---|--|
| 1      | 线圈额定电压 Rated coil volt(VDC)   | ZLJM-250D系列Series                                  |
| 2      | 线圈功率 Coil Power dissipation(W)  | 12, 24, 30, 48, 60, 72, 120等(etc)                  |
| 3      | 触点电路额定电压 Rated volt of contact circuit(V DC)  | 13-20  |
| 4      | 触点电路额定负载电流 Rated load current of contact circuit(A)   | 60   |
| 5      | 触点电路额定电压/动作电压(V)<br>(20~5V下, 无动作电压V)  | 250A   |
| 6      | 额定电压下最大动作时间(ms)(线圈不带抑制电路)<br>(Max. operating time at rated volt(ms)<br>(Coil with no suppression circuit) | 不大于线圈额定电压的0% 不大于70% of rated coil volt             |
| 7      | 抗电强度 Puncture(volt) strength  | 释放 Release 线圈额定电压的5~30% (5~30% of rated coil volt) |
| 8      | 100A负载下主触点接触压降 Contact volt drop at main contact: 100A  | 40   |
| 9      | 电寿命 Electric life   | 50Hz 1000V AC 1min<br>不大于80mV not above 80mV       |
| 10     | 机械寿命 Mechanical life  | 20,000 Ops   |
| 11     | 工作规范 Working duty   | 107万次 100,000 Ops.<br>连续 Continuous                |